

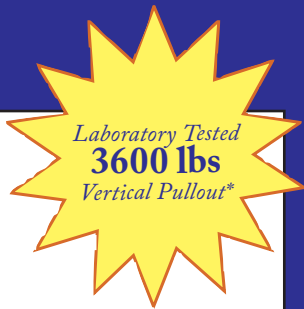

Proprietary base grooves grip roof surface to prevent turning

# FastJack®

## — E-Series — Patent #6,360,491



## Flashable Roof Stanchion

The patented design of the FastJack® E-Series is the most efficient and cost-effective product of it's kind.

The FastJack® E-series has been laboratory tested to 3,600 pounds of vertical pullout strength using a single Stainless Steel lag bolt (included).

Product constructed of only high-quality solid Aluminum and Stainless Steel for corrosion resistance and high strength.

### Two Sizes Available

3" High	Part# FJE-300-18
For low profile installations using Oatey flashings (for composition shingle roofs)	
4-1/2" High	Part# FJE-450-18
For installations using standard flashings (for composition & flat roofs)	

The FastJack® design is covered under Pat. #6,360,491. \*Side lateral pull-out of 1,360 lbs.



All FastJack® attachments are sold in heavy duty recloseable boxes which allow for easy storage and handling.

P/N: FJE-300-18 (3") or FJE-450-18 (4-1/2")

Box includes:

(18) 1" Solid Aluminum Posts	(18) 3/8" SS Flat Washers
(18) 1-1/2" Aluminum Bases	(18) 5/16" x 3-1/2" SS Lag bolts
(18) 3/8" x 3/4" SS Bolts	(18) 5/16" SS Flat Washers

FastJack® FJE-300-18  
For Oatey® style flashings



FastJack® FJE-450-18  
For standard height flashings



### USED FOR MOUNTING:

- Photovoltaic Solar Panels
- Solar Thermal Panels
- Communication Equipment
- Virtually anything needing structural attachment to a roof!

Commercial FastJack® E-Series (single lag bolt design) also available.  
Tested to 4,050 lbs. See back for details.

### Benefits of the FastJack®

- Removable post makes installation on existing roofs quick and easy as flashing can be installed with no post obstruction (see illustration to the right)
- Patented design locates the lag bolt directly below the stanchion, providing superior strength values
- Precision machined from aluminum, no welds to corrode or break
- Significantly lighter than steel for installer convenience and reduced shipping costs
- Base design works with all standard roof flashings

### Easy installation of flashings on existing roof-tops

See reverse for installation theory

Standard & Oatey®  
Flashings slip over  
the base and under the  
delicate shingle

The post can  
be installed  
through the  
top of the  
flashing

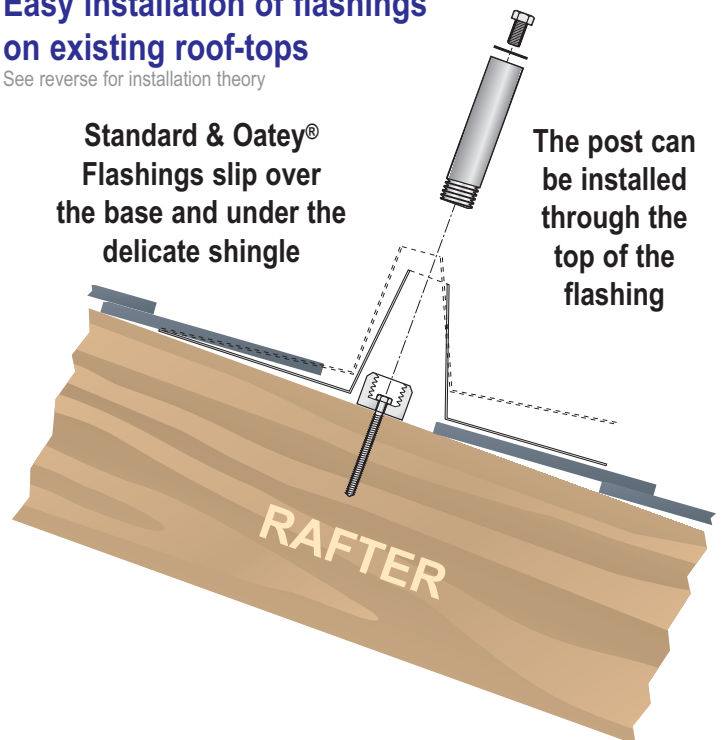

professional  
**SOLAR**  
products inc.

(805) 486-4700

(805) 486-4799—fax  
1551 S. Rose Ave.  
Oxnard, CA 93033

View more info on our  
website at:

[www.prosolar.com](http://www.prosolar.com)

Email us for  
more information

[prosolar@prosolar.com](mailto:prosolar@prosolar.com)

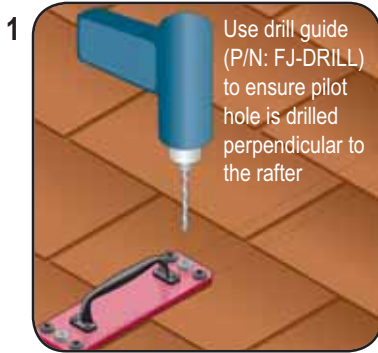

1 Use drill guide (P/N: FJ-DRILL) to ensure pilot hole is drilled perpendicular to the rafter

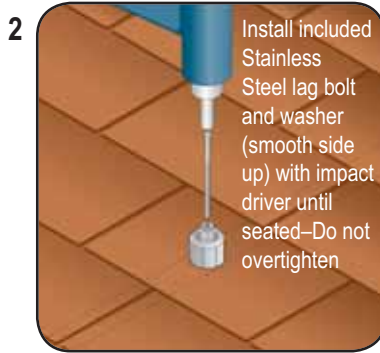

2 Install included Stainless Steel lag bolt and washer (smooth side up) with impact driver until seated—Do not overtighten

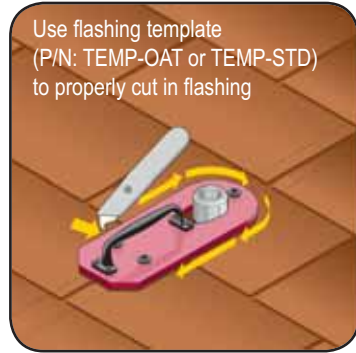

3 Use flashing template (P/N: TEMP-OAT or TEMP-STD) to properly cut in flashing

### Steps 4–6 for Oatey® flashings only

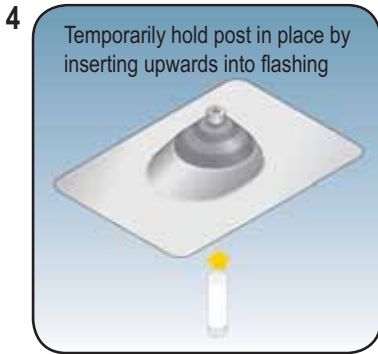

4 Temporarily hold post in place by inserting upwards into flashing



5 Insert flashing, aligning post and base

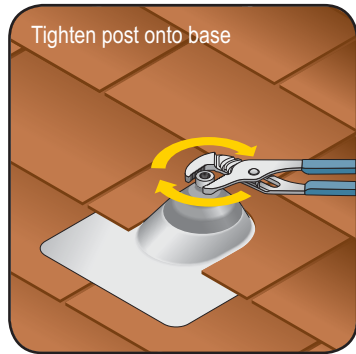

6 Tighten post onto base

### Steps 7–9 for standard metal flashings only

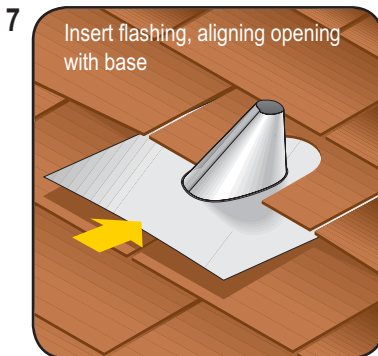

7 Insert flashing, aligning opening with base

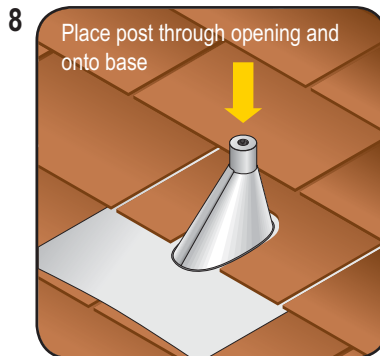

8 Place post through opening and onto base

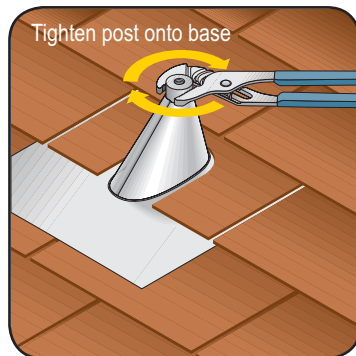

9 Tighten post onto base

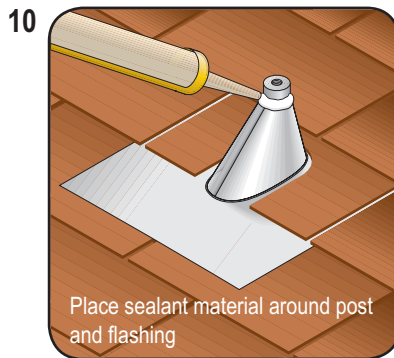

10 Place sealant material around post and flashing



**Commercial FastJack® E-series**  
 Lab tested to 4,050 lbs vertical pullout\*  
\*Using 3/8" x 4" SS lag bolt (not included). 1,875 side axial pullout.

**Two Sizes Available**

<b>4" High</b>	<b>Part# CFJE-400-18</b>
Post top threaded for standard 3/8" bolt, 2" round base, accepts 3/8" lag bolt	
<b>6" High</b>	<b>Part# CFJE-600-18</b>
Post top threaded for standard 3/8" bolt, 2" round base, accepts 3/8" lag bolt	

Box includes:  
 (18) 1-1/4" Solid Aluminum Posts  
 (18) 2" Aluminum Bases

## Accessories



**Flashing Template**  
 Makes cutting in flashing easy and accurate. Available in two sizes for Oatey® (Part# TEMP-OAT) shown and standard metal flashings (Part# TEMP-STD).



**Drill Guide**  
 Helps ensure proper pilot hole drilling. Includes both drill guides for FJE (3/16") and CFJE (1/4") product lines. (Part# FJ-DRILL)



**Clear Flashing**  
 Low profile, UPC, NES 653 approved. Color: clear (Part# OAT-SF)



**Black Flashing**  
 Low profile, UPC, NES 653 approved. Color: black (Part# OAT-SF-B)